

THERMO HS - Lift and slide balcony door

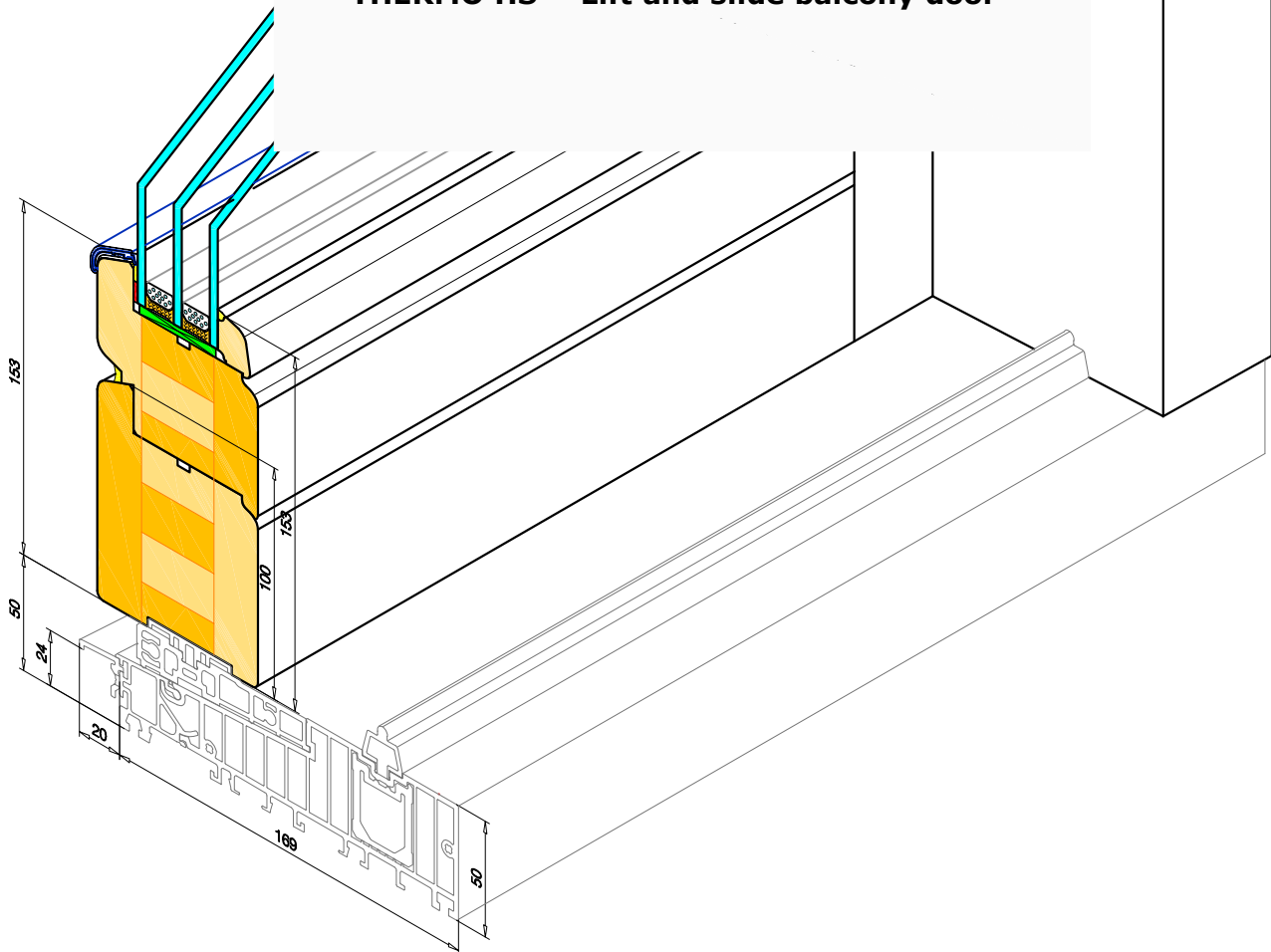

	<i>technical issue</i>	<i>description</i>	<i>notes</i>
1	Construction	HS	
2	Material	<ul style="list-style-type: none"> - pine fingerjointed, - pine sorted (not fingerjointed), - meranti, - oak, 	
3	Fittings options	<p style="text-align: center;">Colour of fittings and accessories</p> <ul style="list-style-type: none"> - silver EV1, - white RAL9003, - dark brown RAL8022, - middle brown C33. <p style="text-align: center;">Remote control system MHS 400 possible on request.</p>	
4	Shapes	Rectangle only	
5	Size	<p style="text-align: center;">Sash width:</p> <ul style="list-style-type: none"> - min. 720mm, - max 3335mm, <p style="text-align: center;">Overall height - max 2800mm</p> <p>Max. sash weight: 400kg</p>	
6	Glass	Glass set thickness - 24mm - 42mm.	
7	TIMBER FINISH	Final painting with water-based opaque paints or staines	
8	COLOUR	<ul style="list-style-type: none"> - opaque: RAL 9016 (white), - Stain: Pine TM367, Afromozja TM4239, Mahogany TM1530, Palisander TM1705, Teak TM1703, Cyprys TM5207, Venge TM9012, Nut TM1515, Graphite TM1504, 	
9	GLAZING BARS	<ul style="list-style-type: none"> - construcion (structural) bars 80mm, - vienna (glued-on) bars 12x24mm, - internal glazing bars (inside insulated glass unit), 	
10	SILICONE	<ul style="list-style-type: none"> - transparent, 	

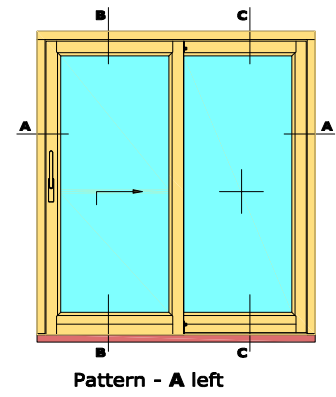

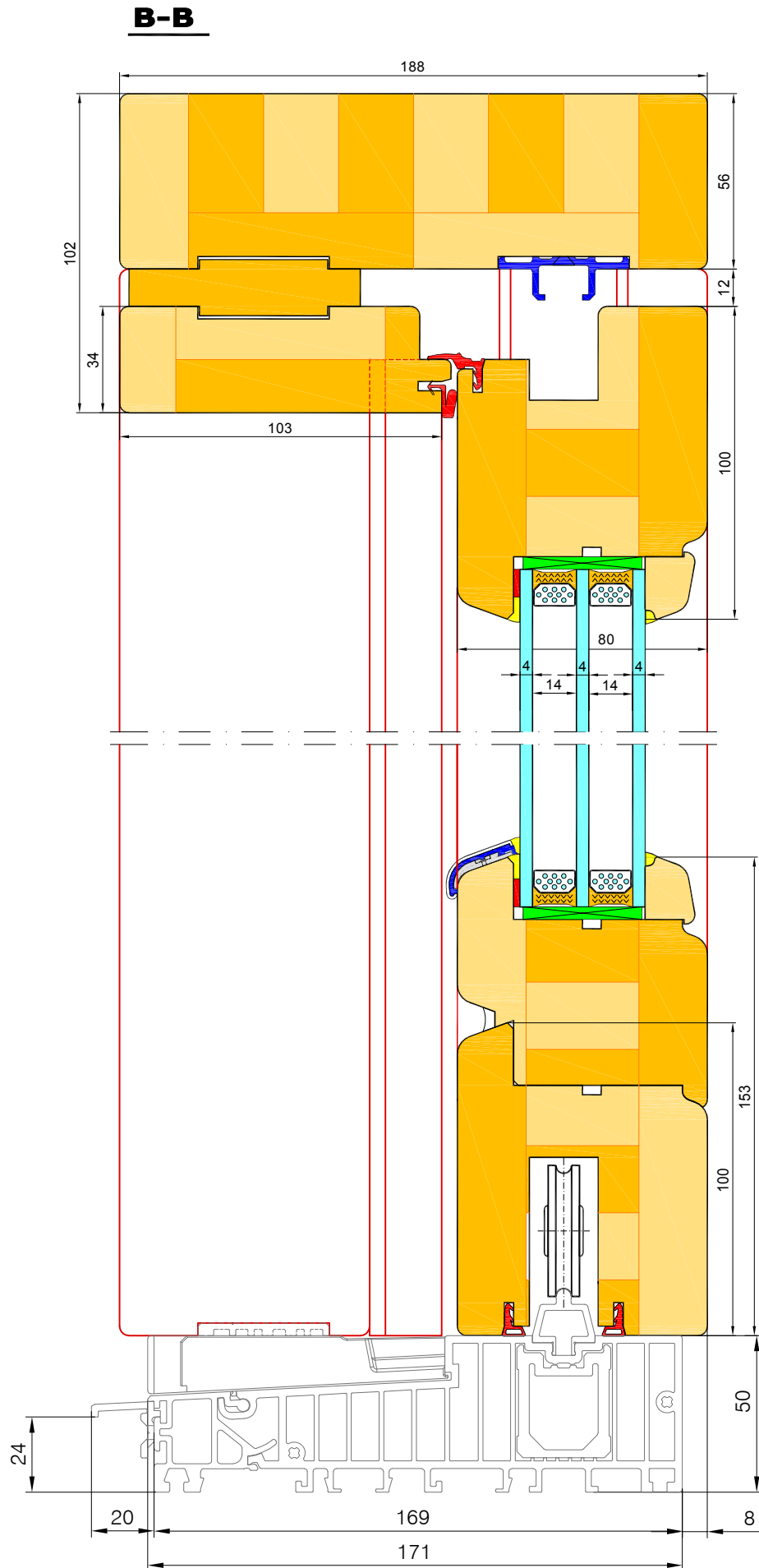
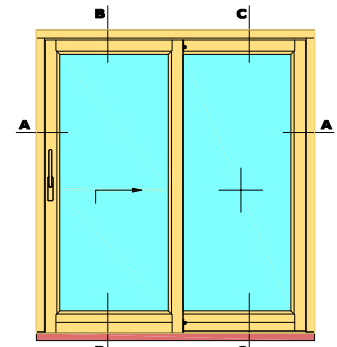
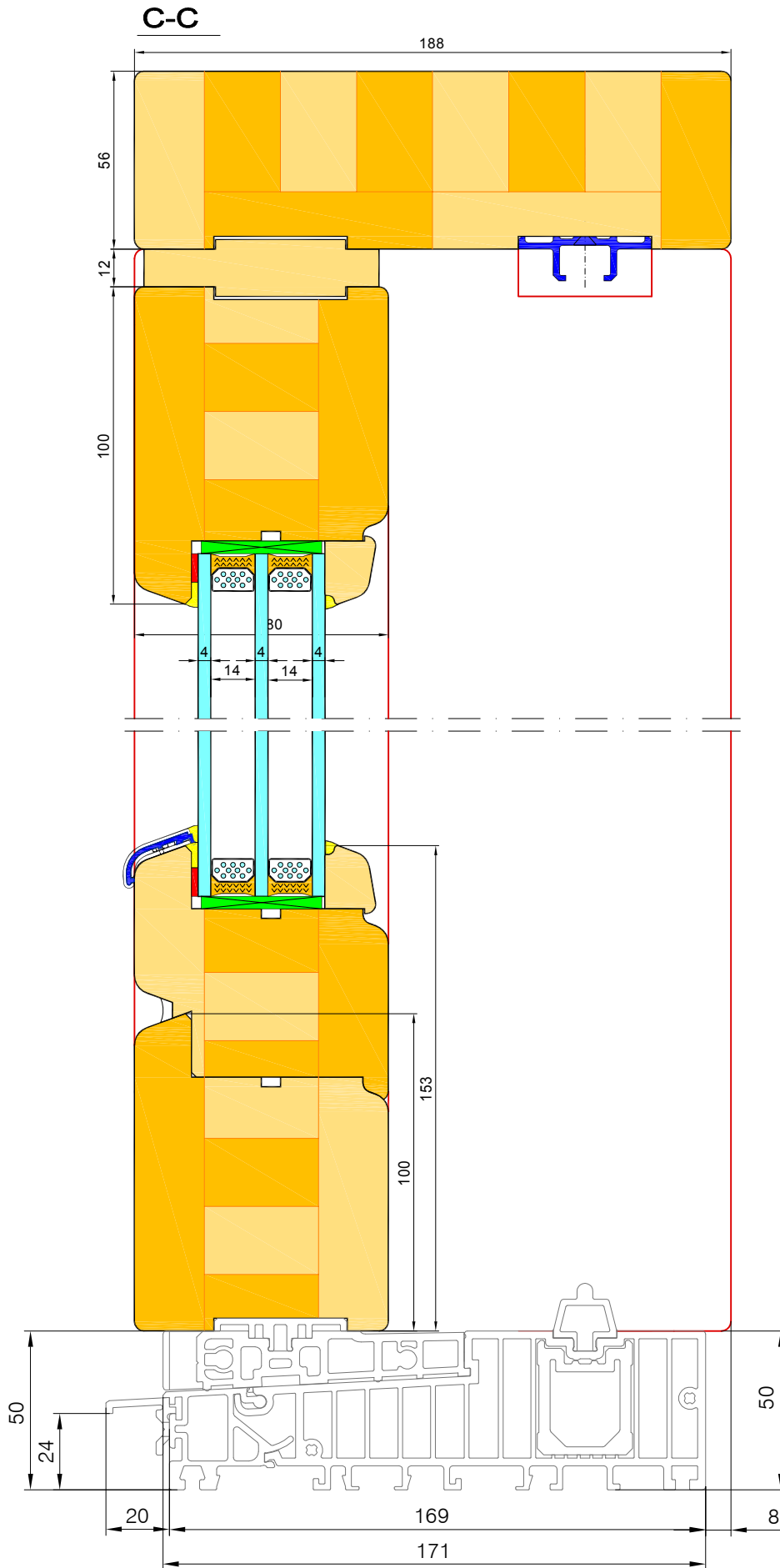

Pattern - A left

THERMO HS - Lift and slide balcony door

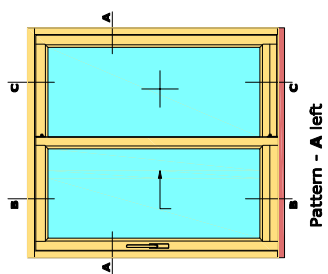

A-A

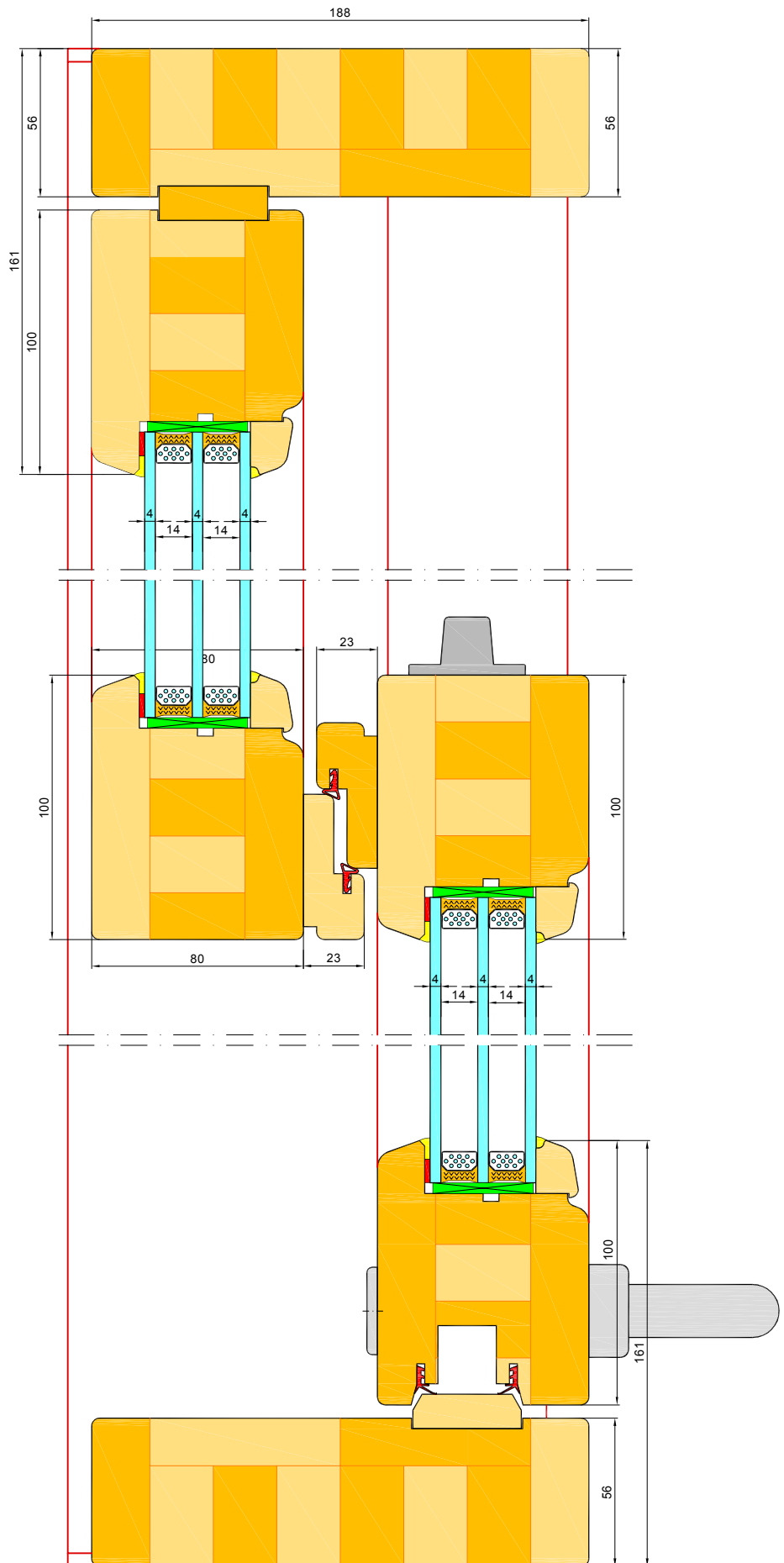

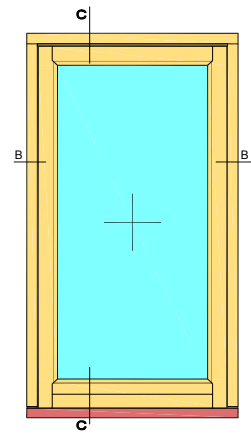
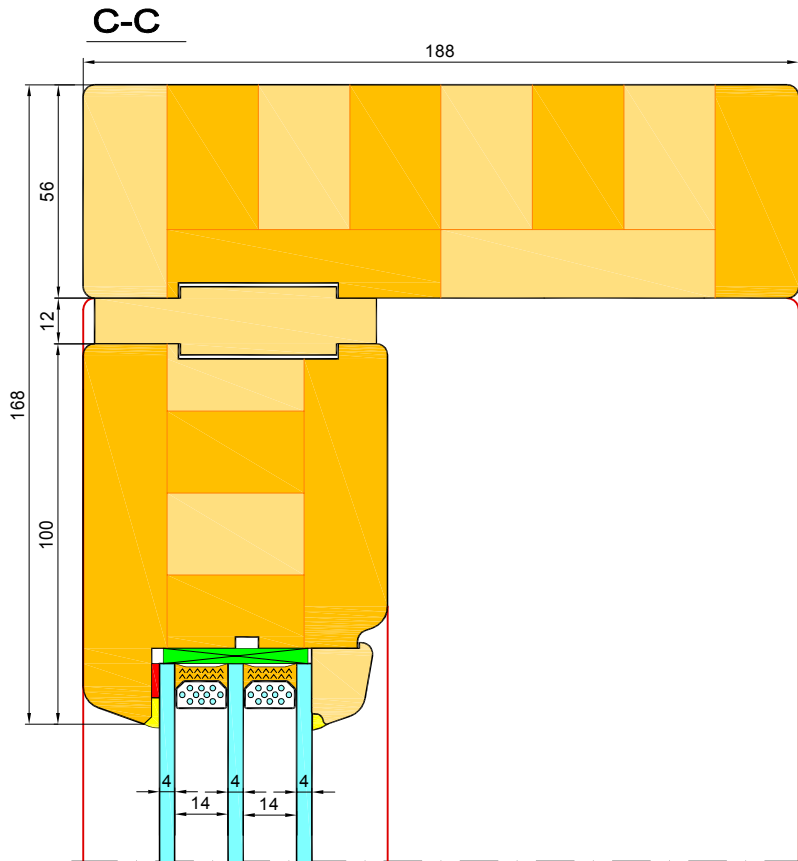

Pattern - FIX

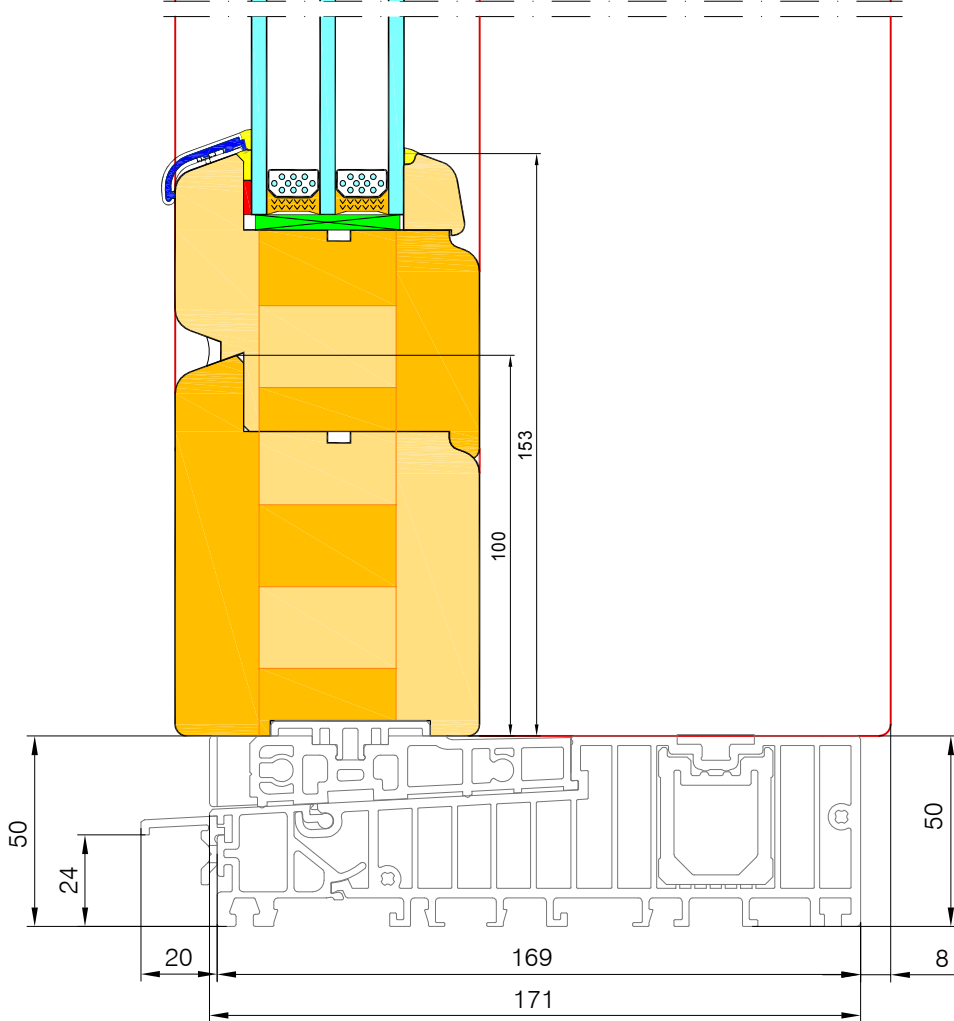

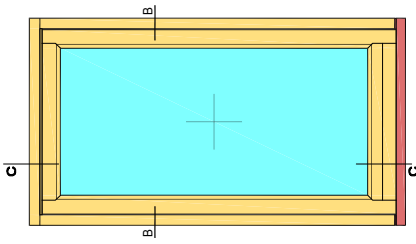

Pattern - FIX

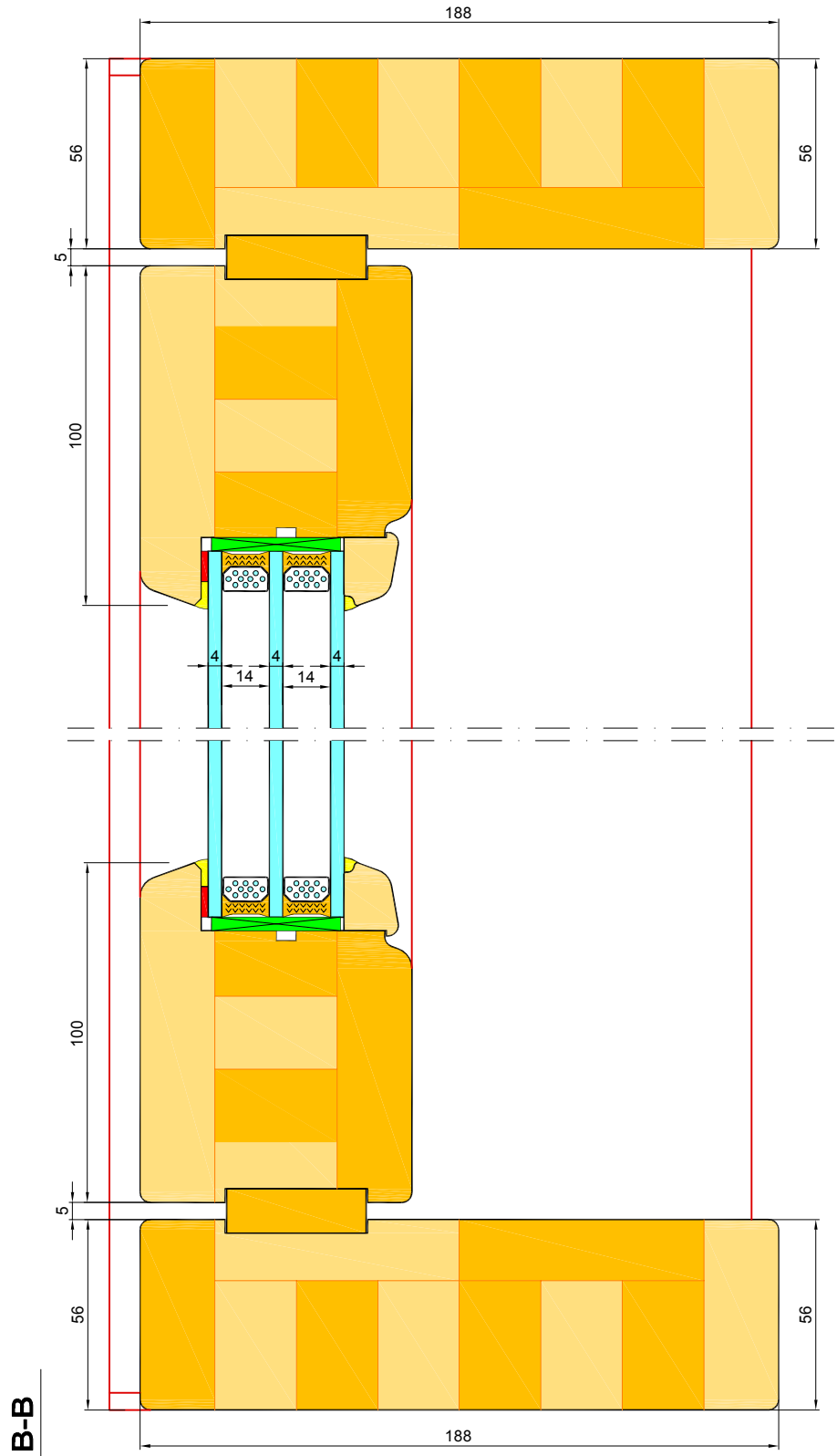

B-B

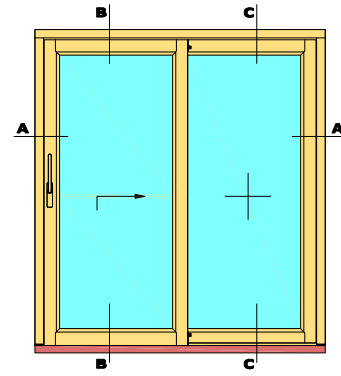
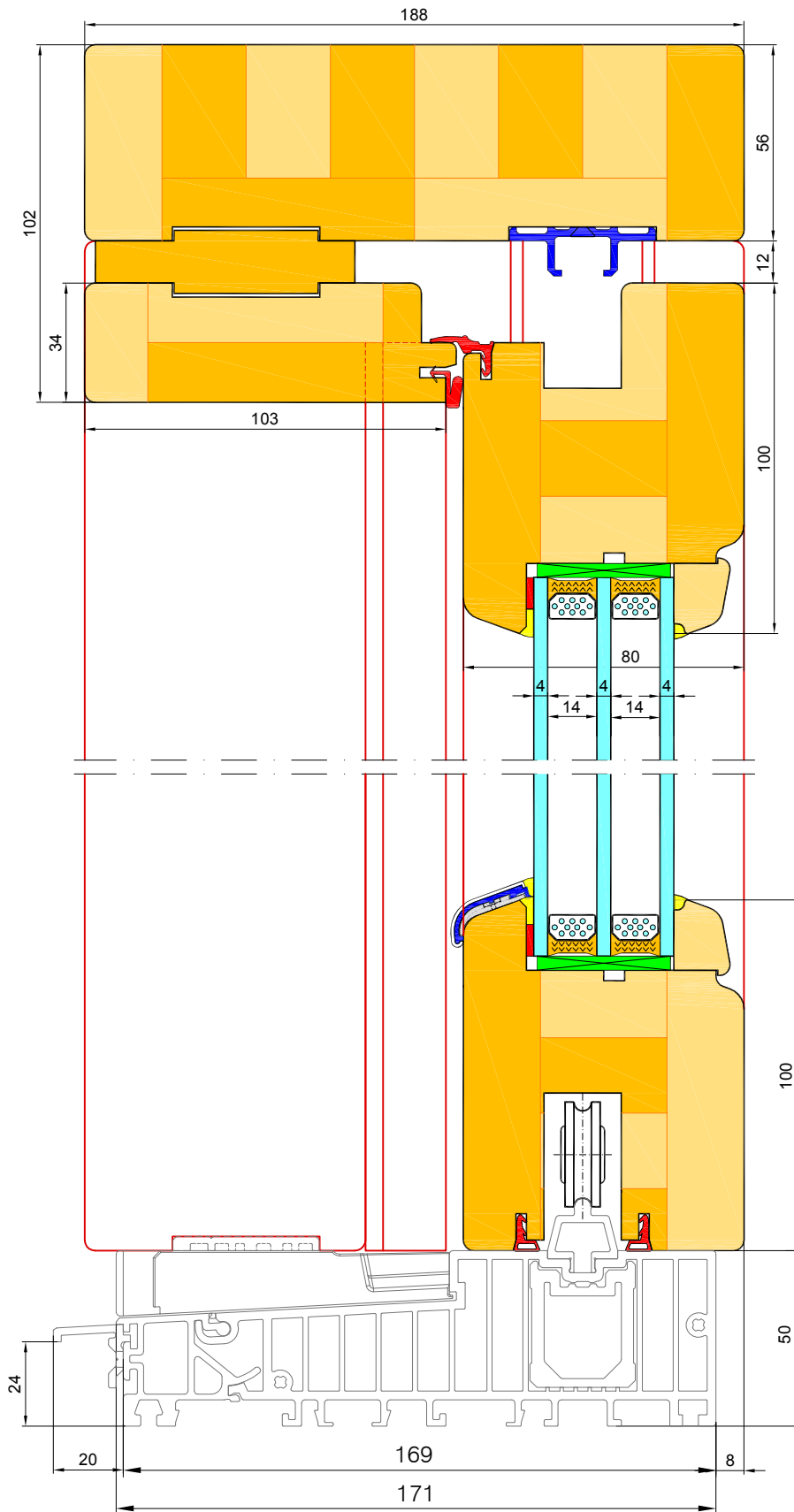

Pattern - A left

Without sash
conterprofile

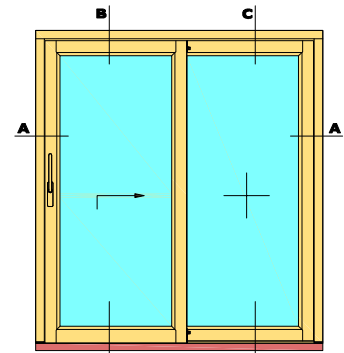
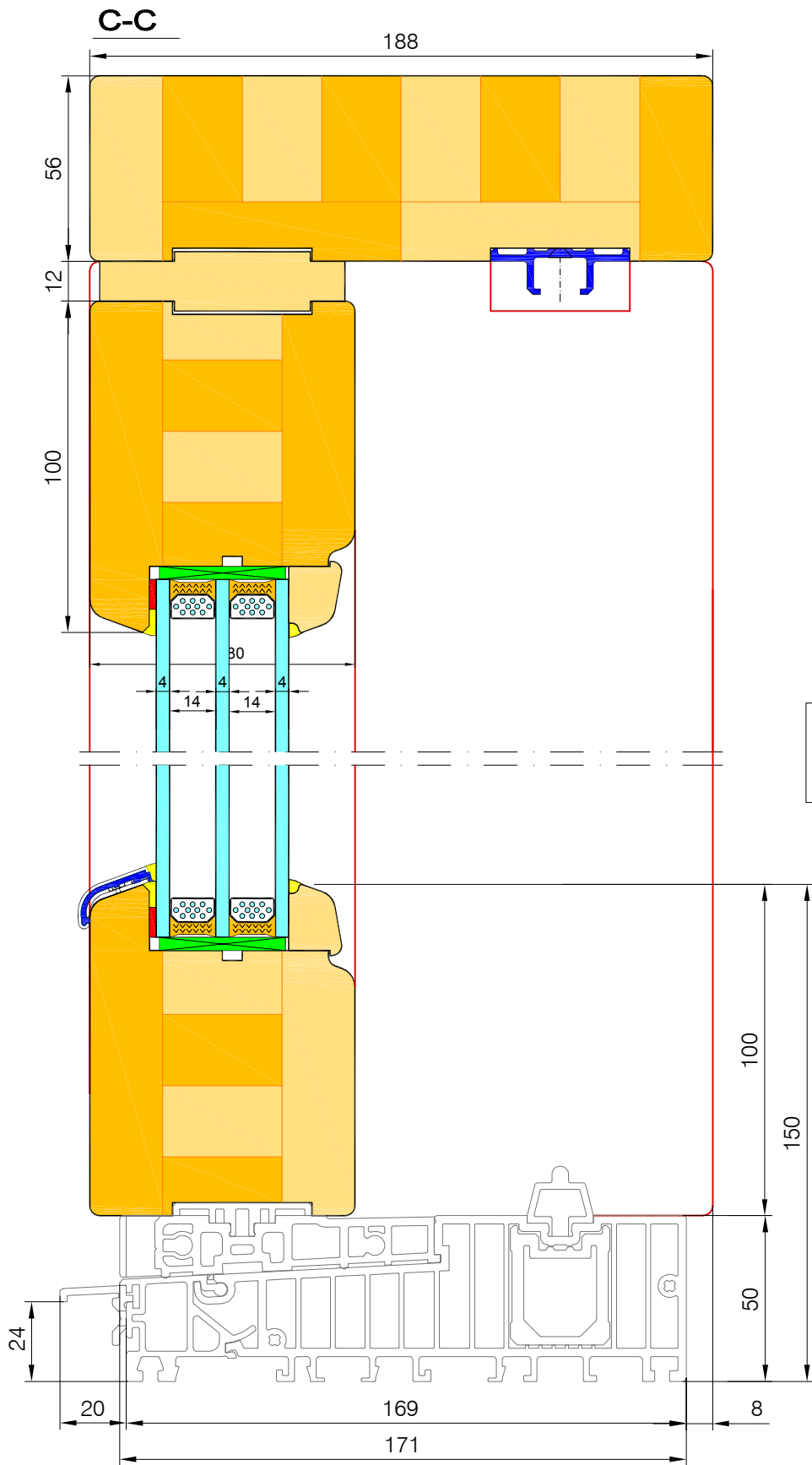

Pattern - A left

Without sash
conterprofile

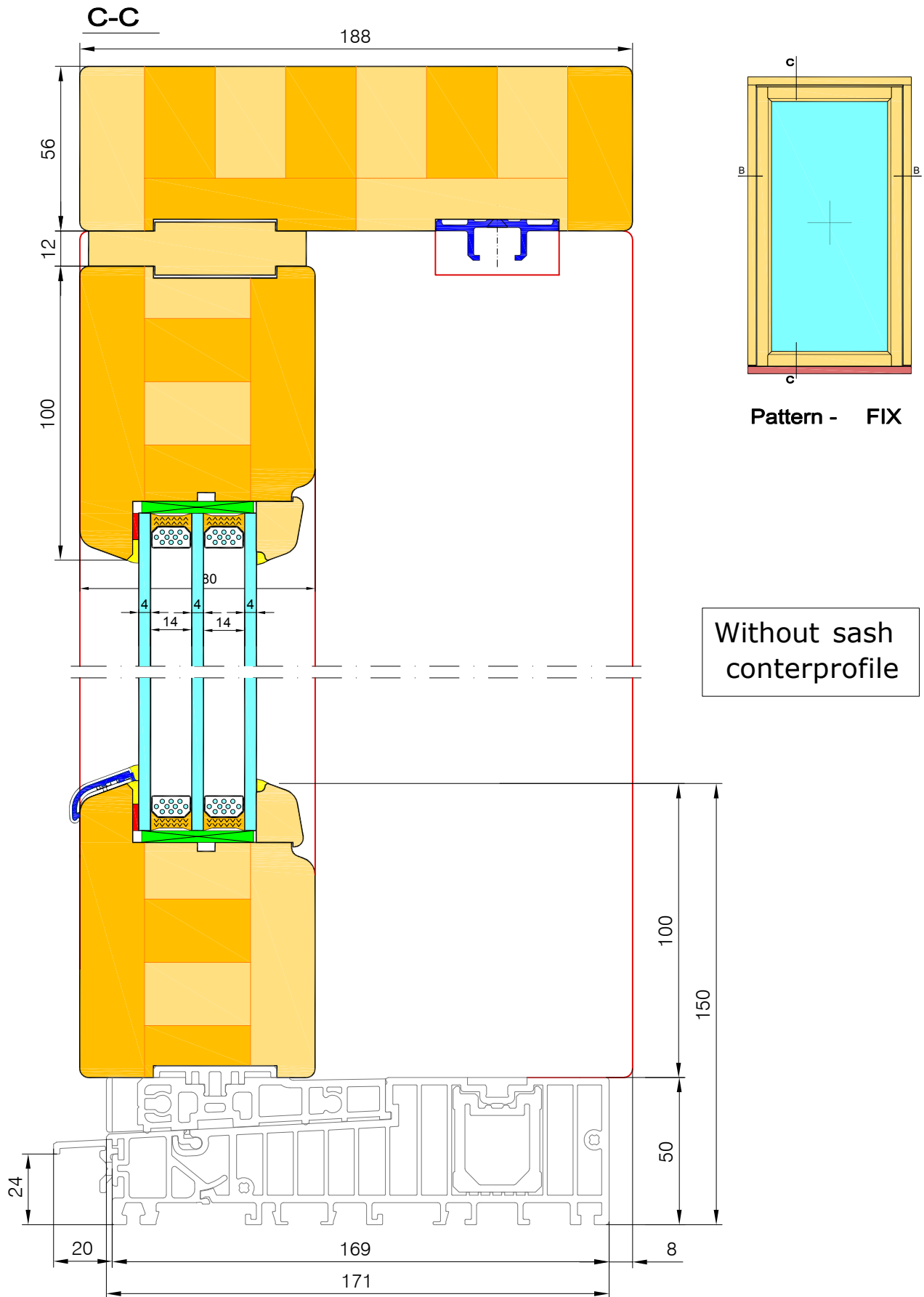

Pattern - C

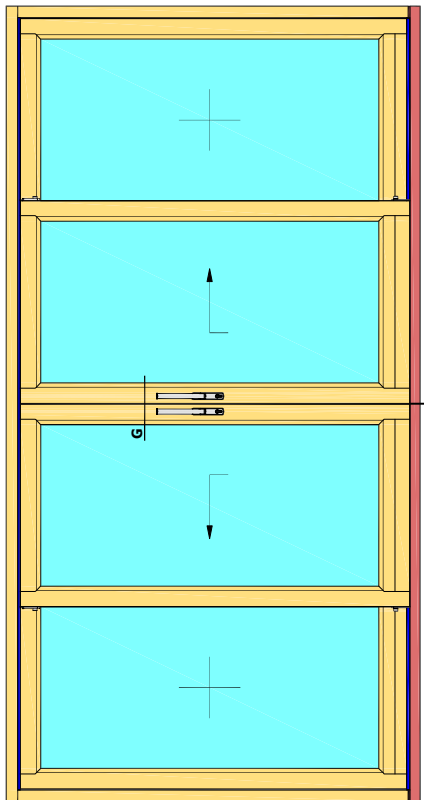

G-G

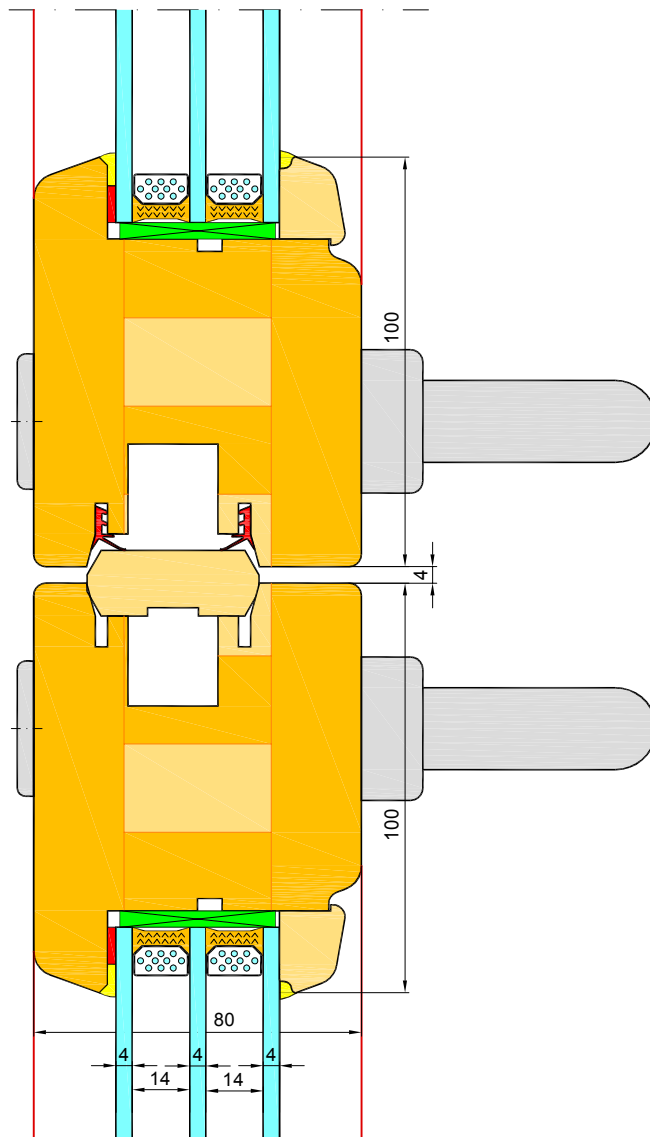

THERMO HS - Lift and slide balcony door

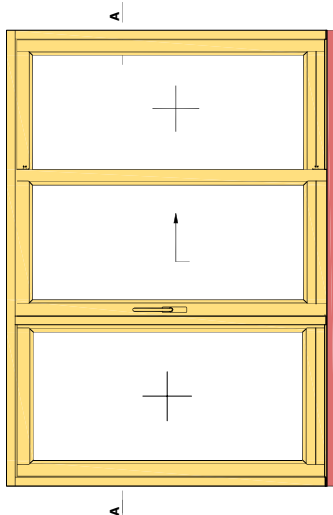

Pattern - G-2

A-A

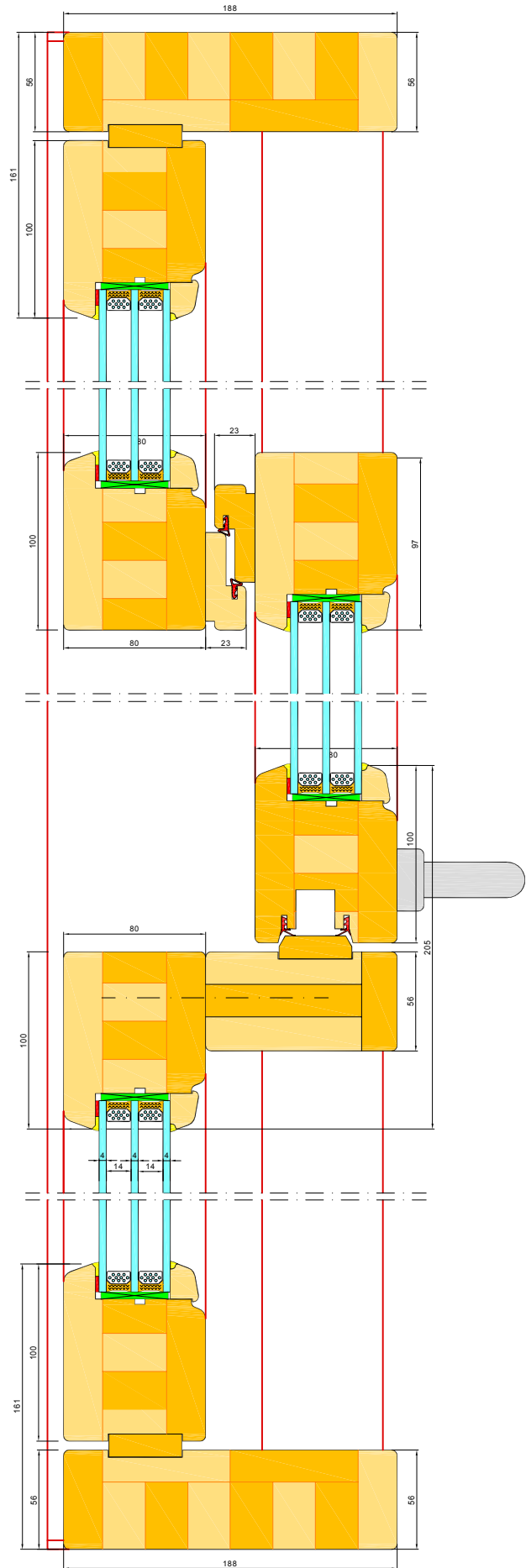

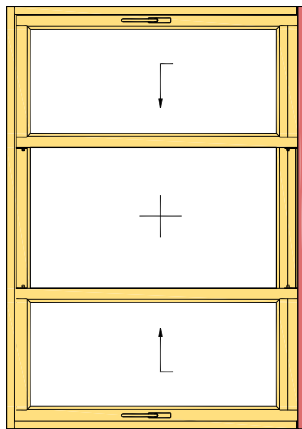

Pattern - K

A-A

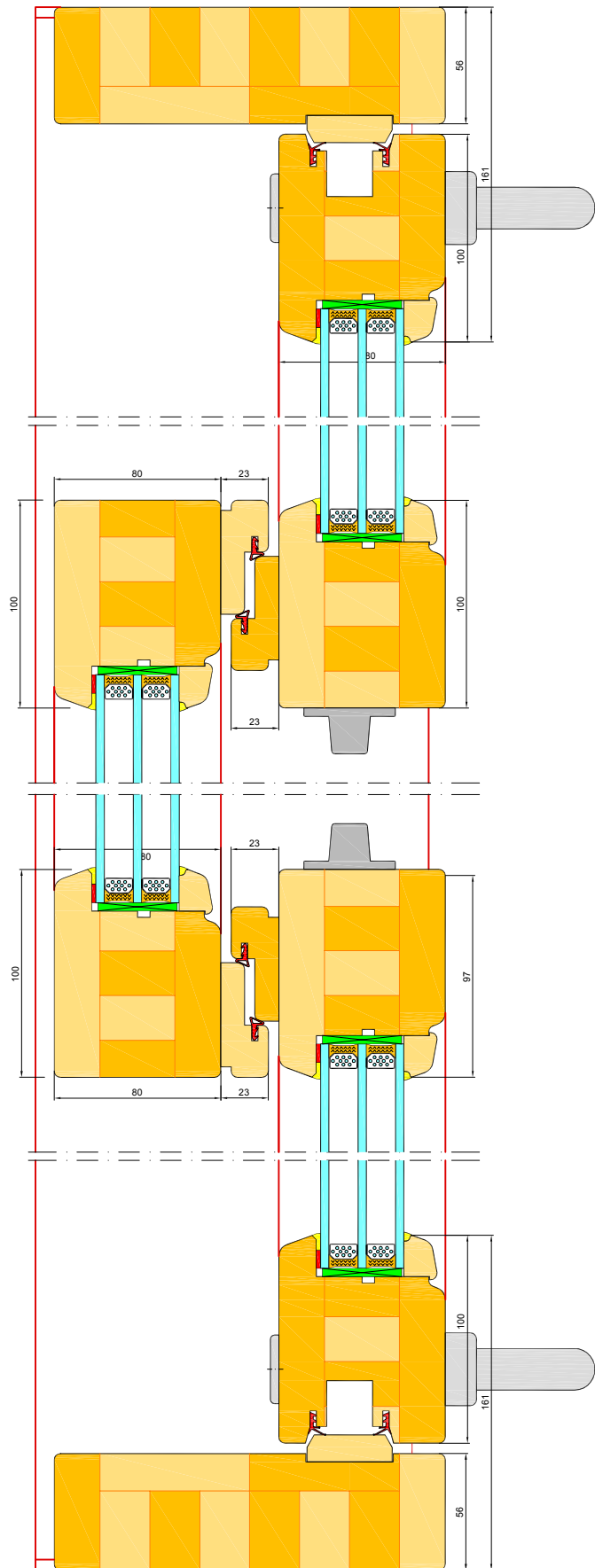

THERMO HS - Lift and slide balcony door

Pattern - E

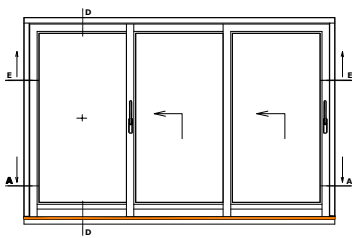

D-D

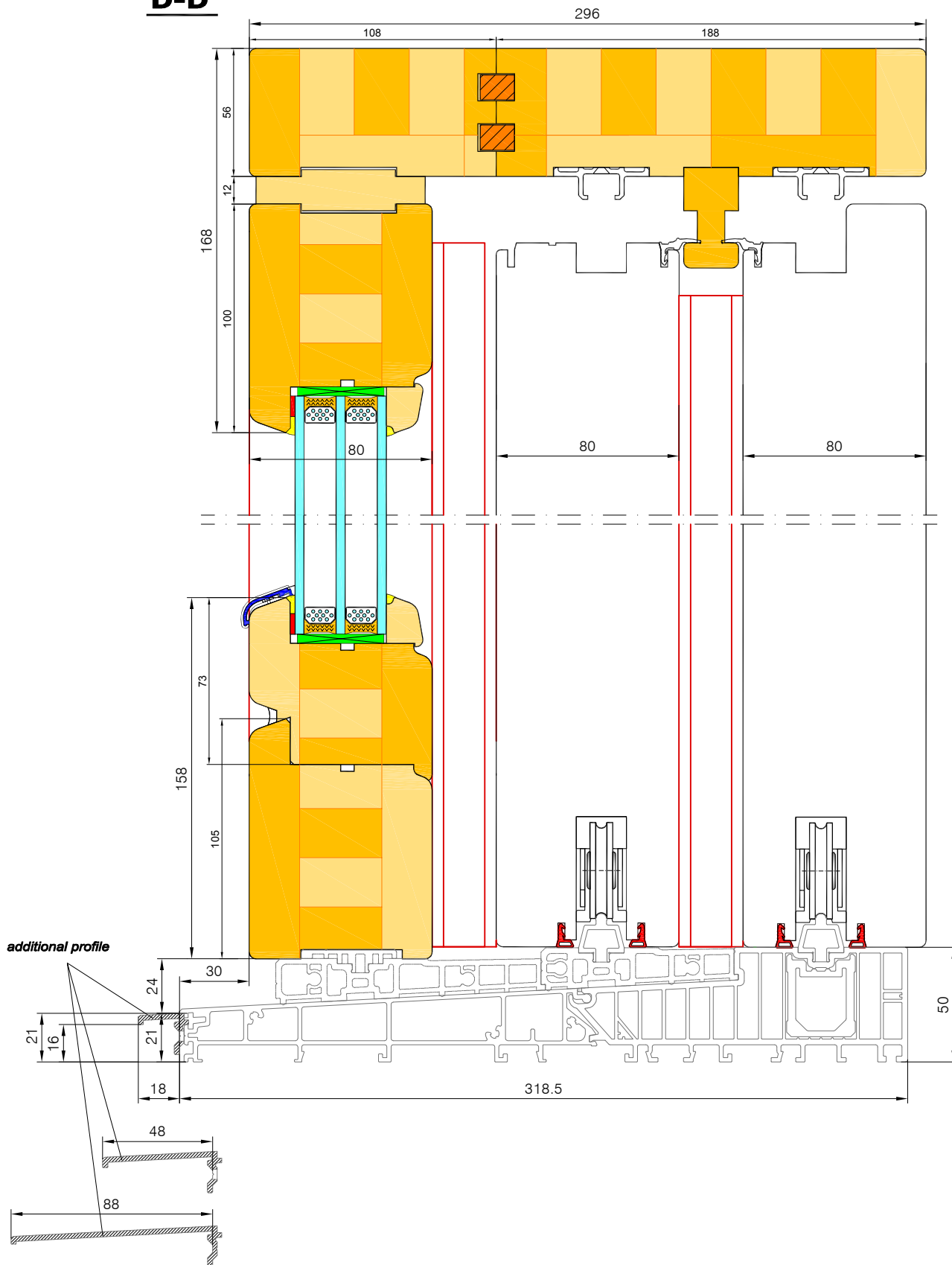

THERMO HS - Lift and slide balcony door

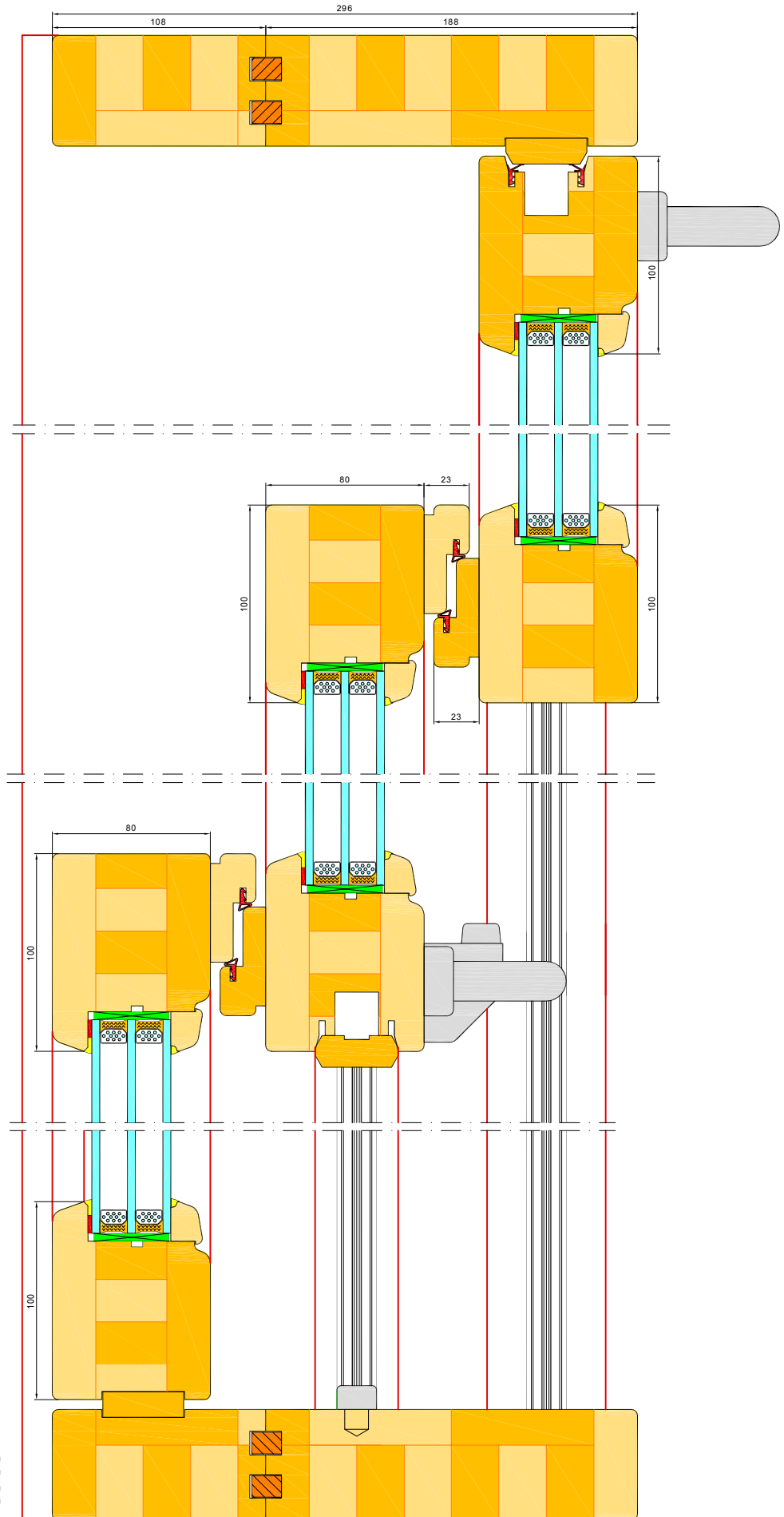

Pattern - E

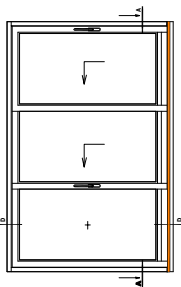

A-A

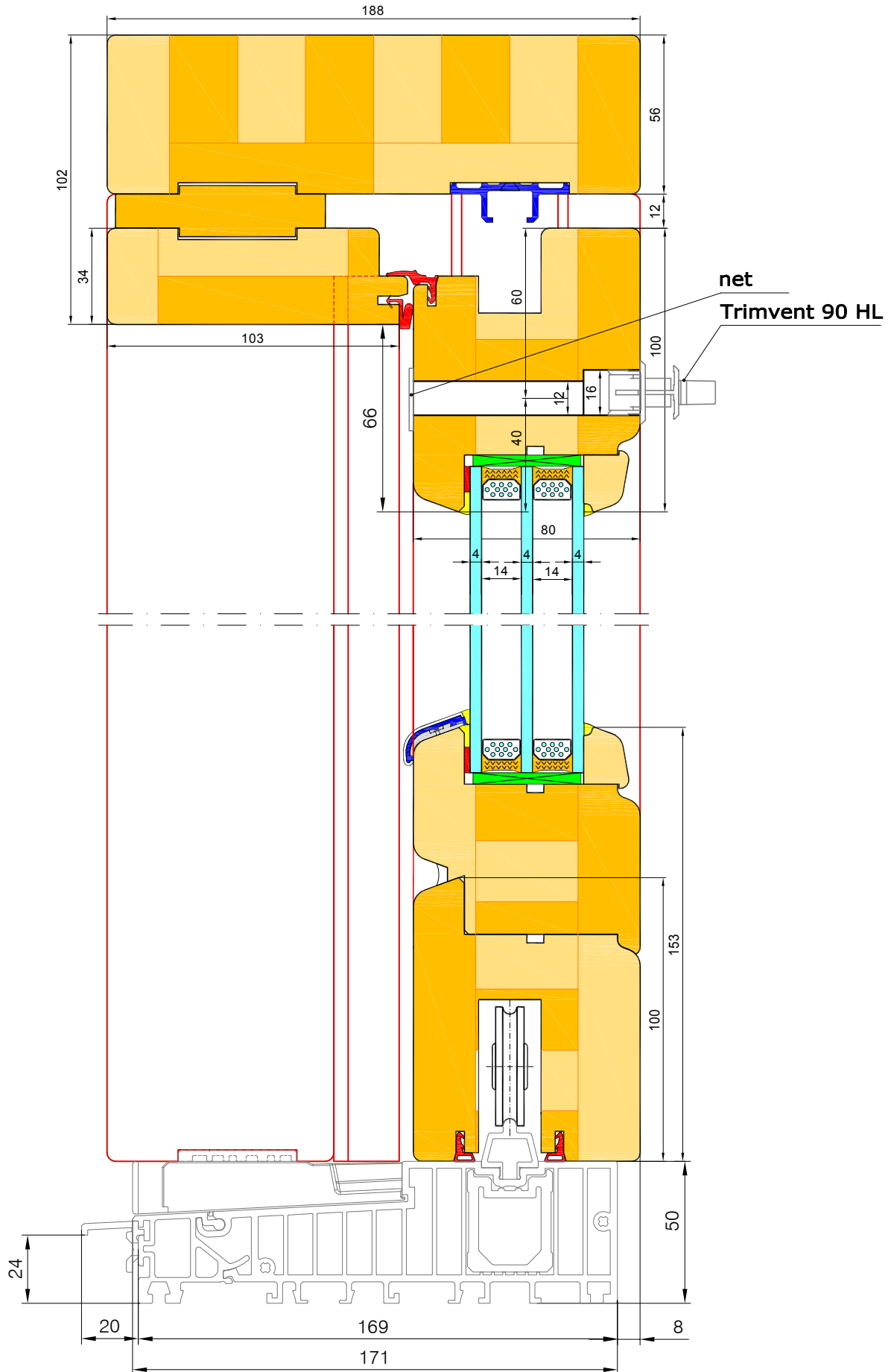

Square glazing bead

B-B

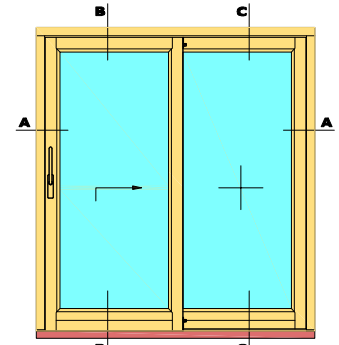
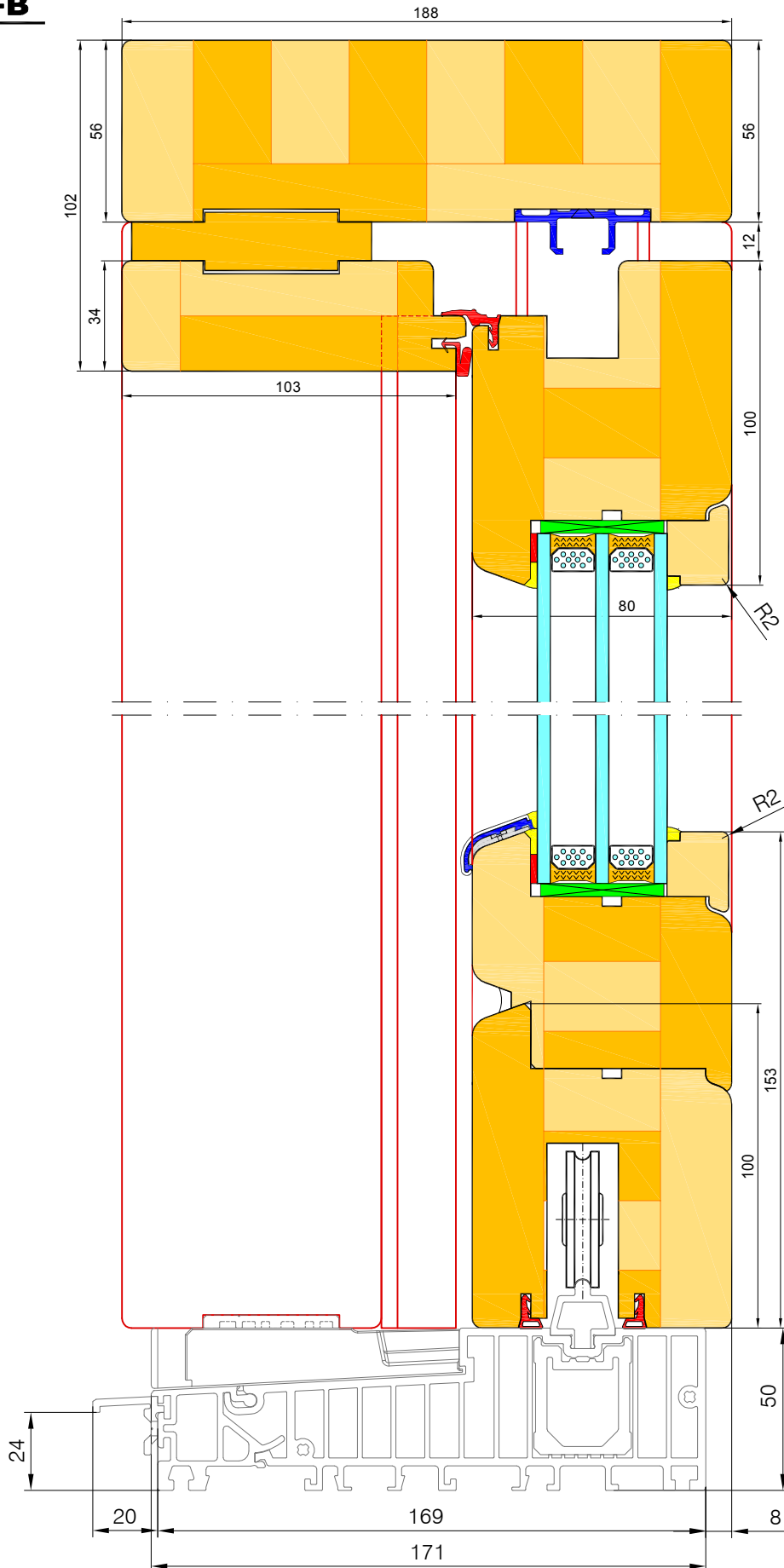

Pattern - A left

Listwa przyszybowa - kanciasta.

BEZ KONTRPROFILU
SKRZYDŁA

B-B

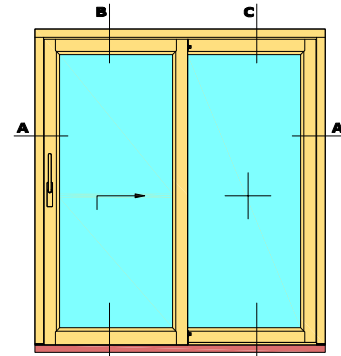
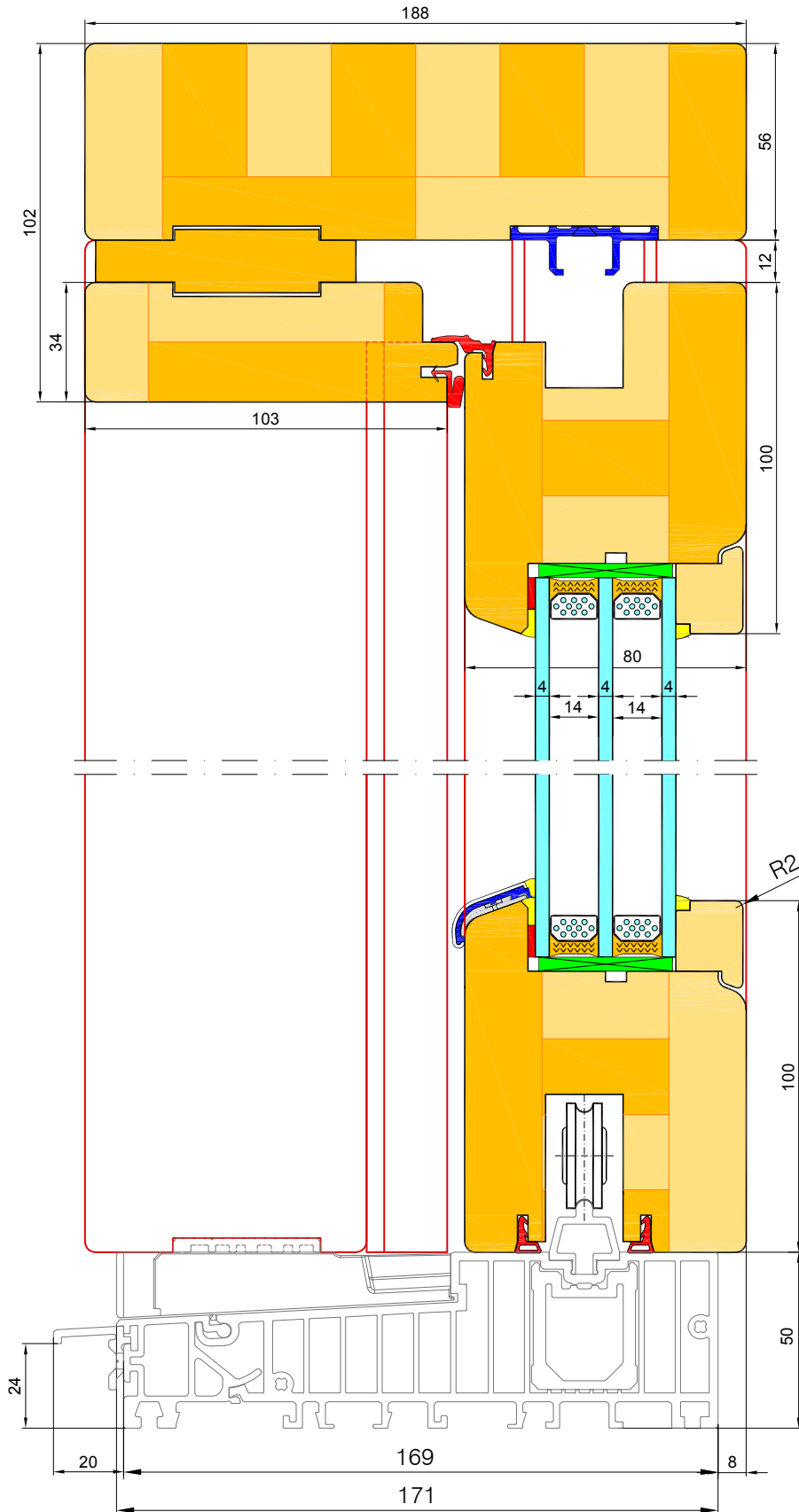

Schemat - A lewy

THERMO HS - clear opening

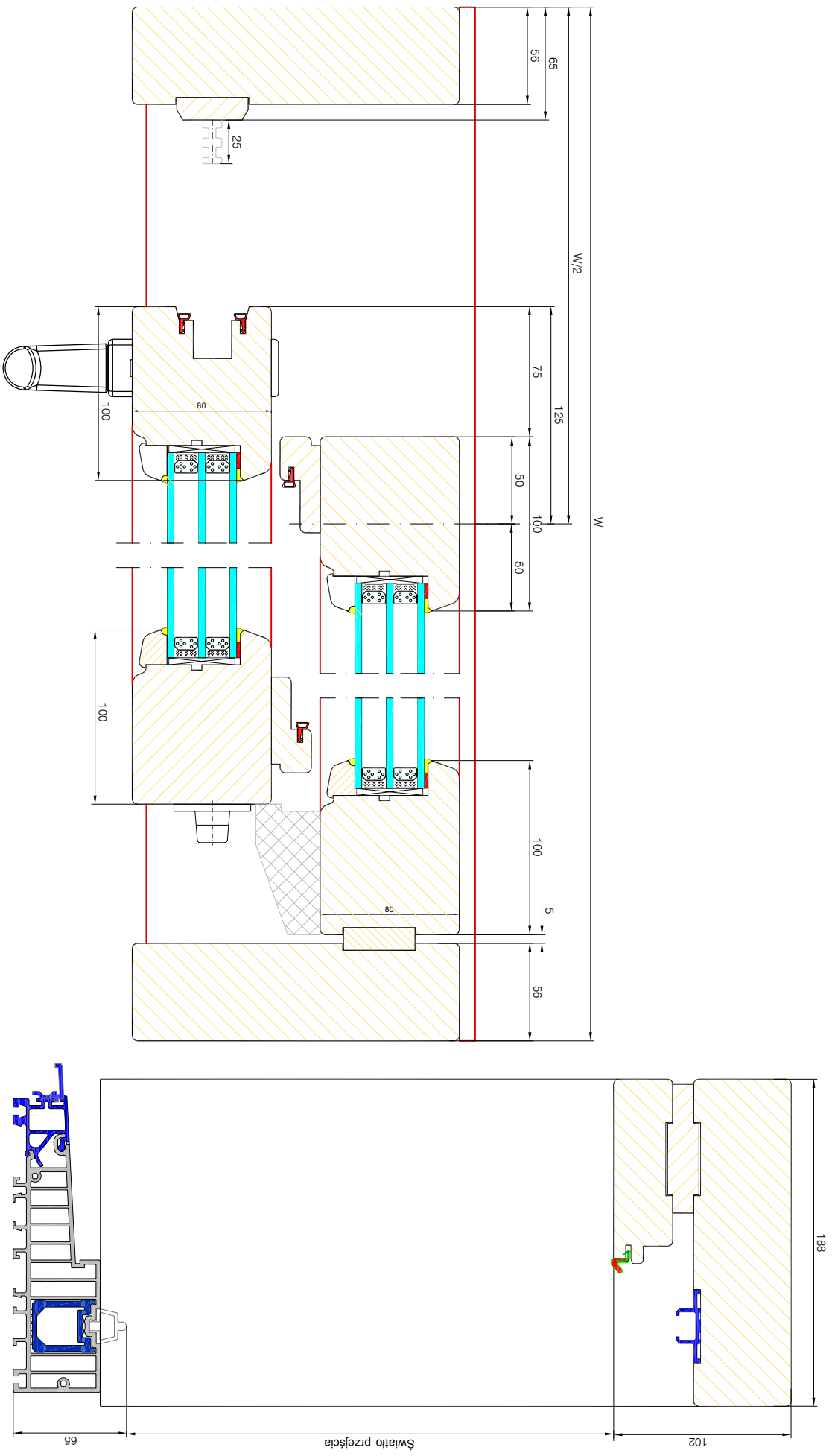

Swiatło przejścia

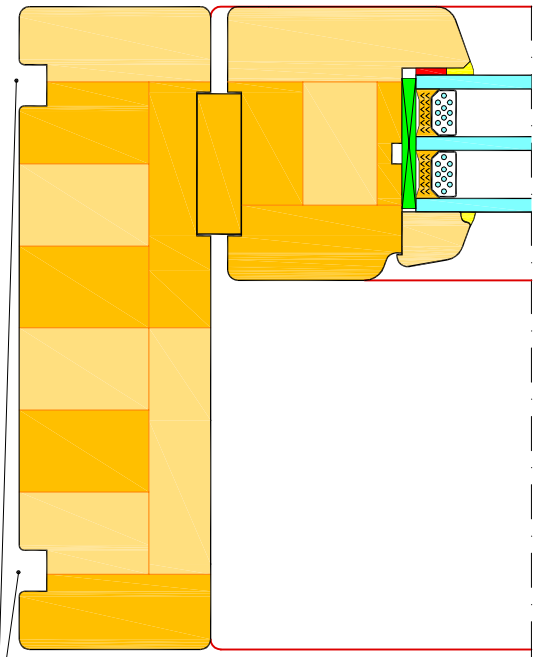
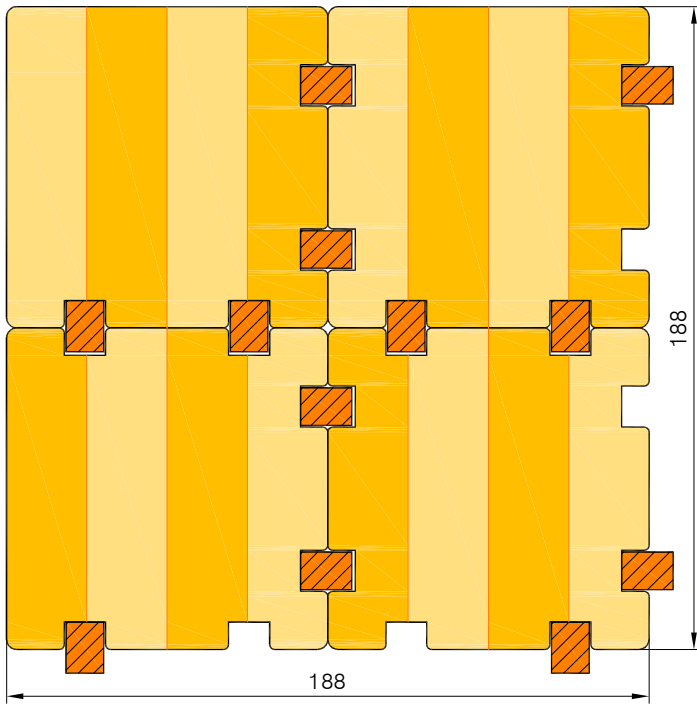

(Only groove without counterprofile)

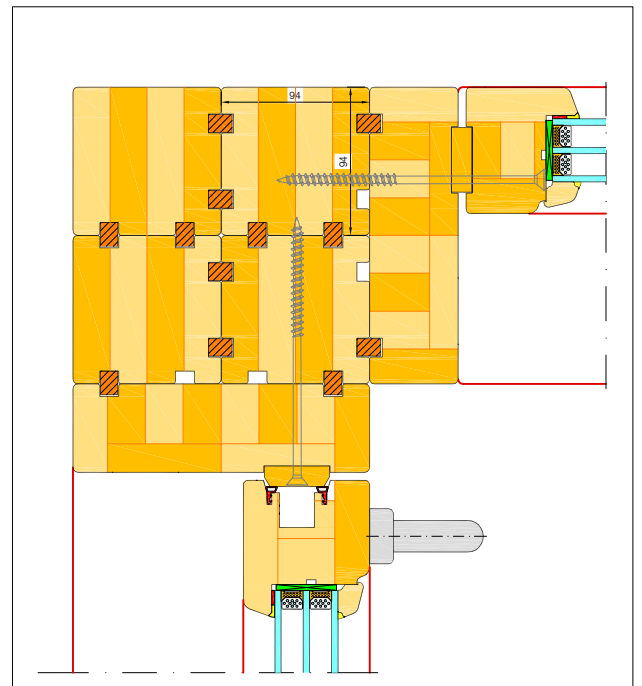
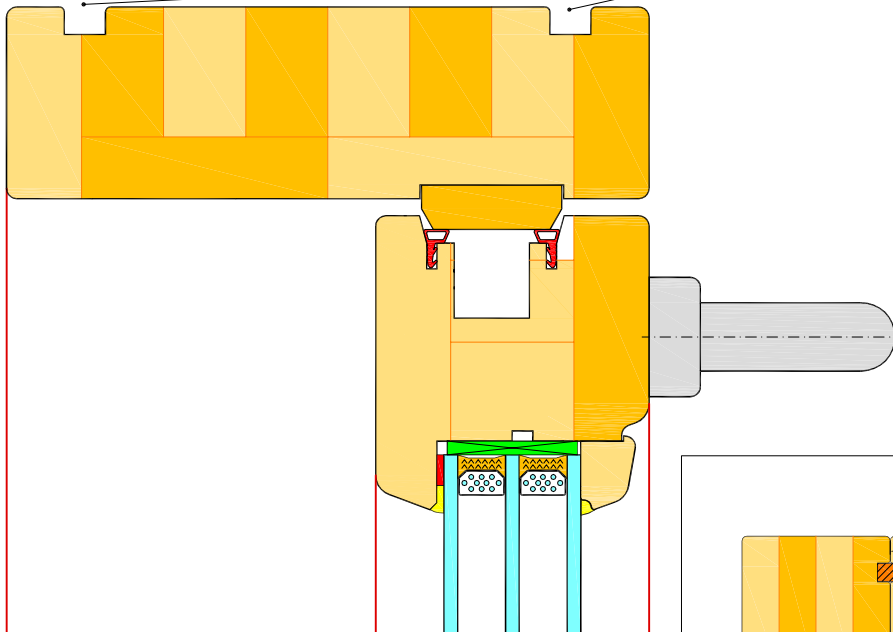

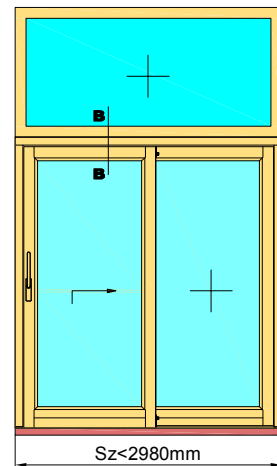
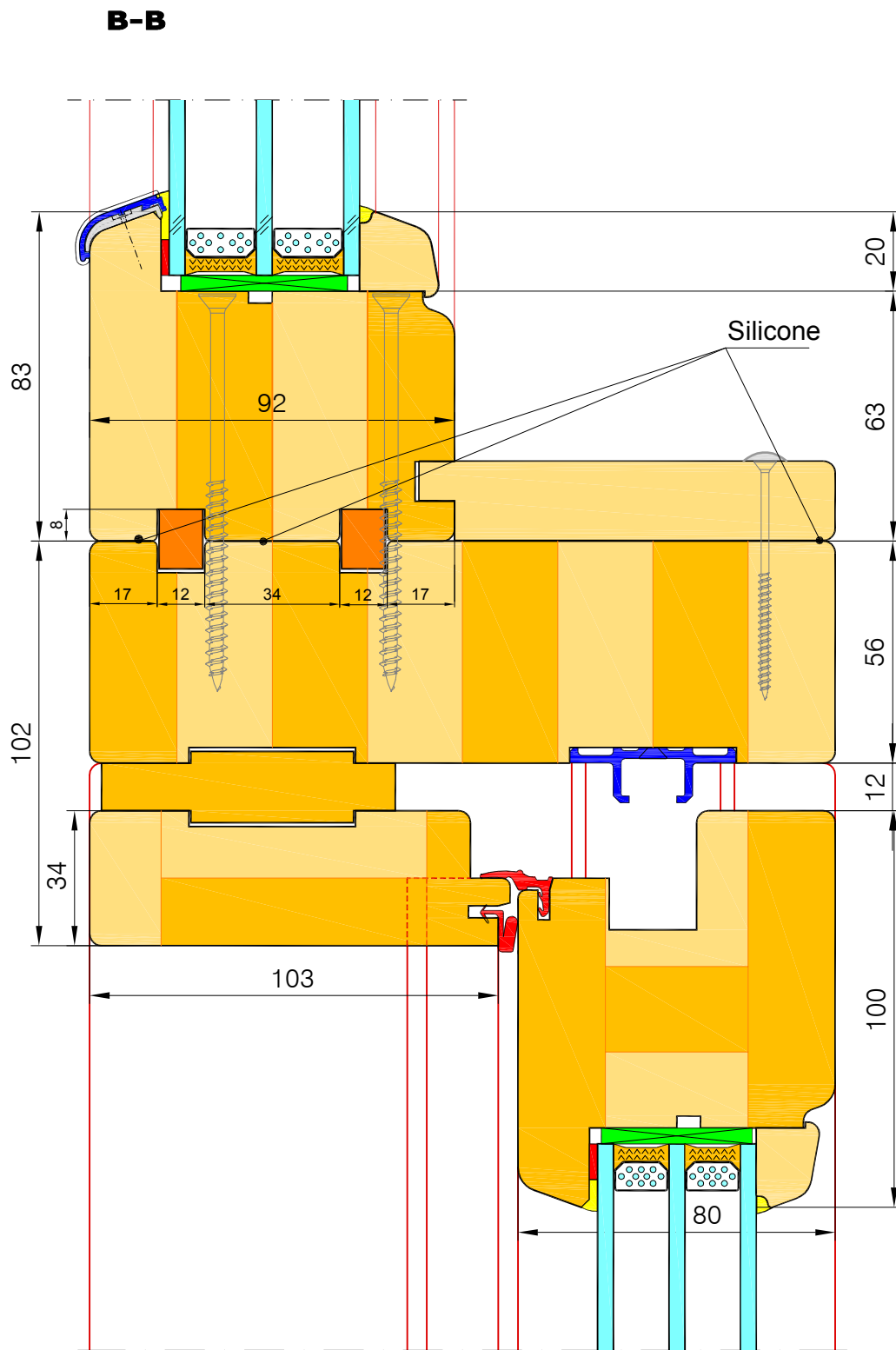

NOTE: make drilling for mounting screws. Hole diameter equal to screw core diameter.

C-C

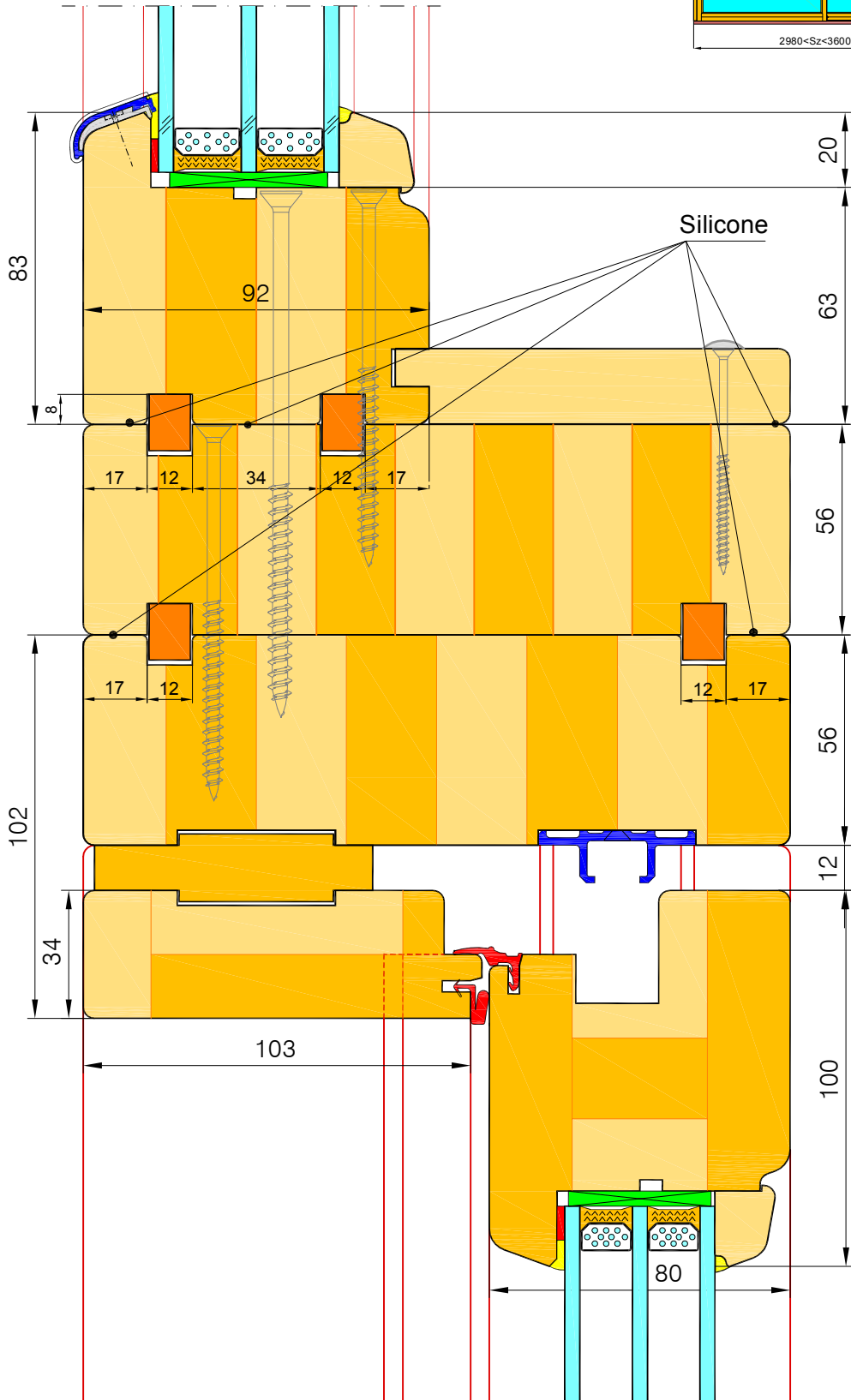
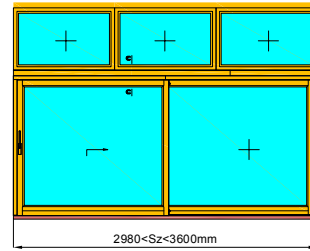

NOTE: make drilling for mounting screws. Hole diameter equal to screw core diameter.

D-D

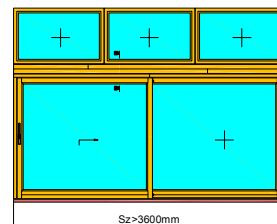
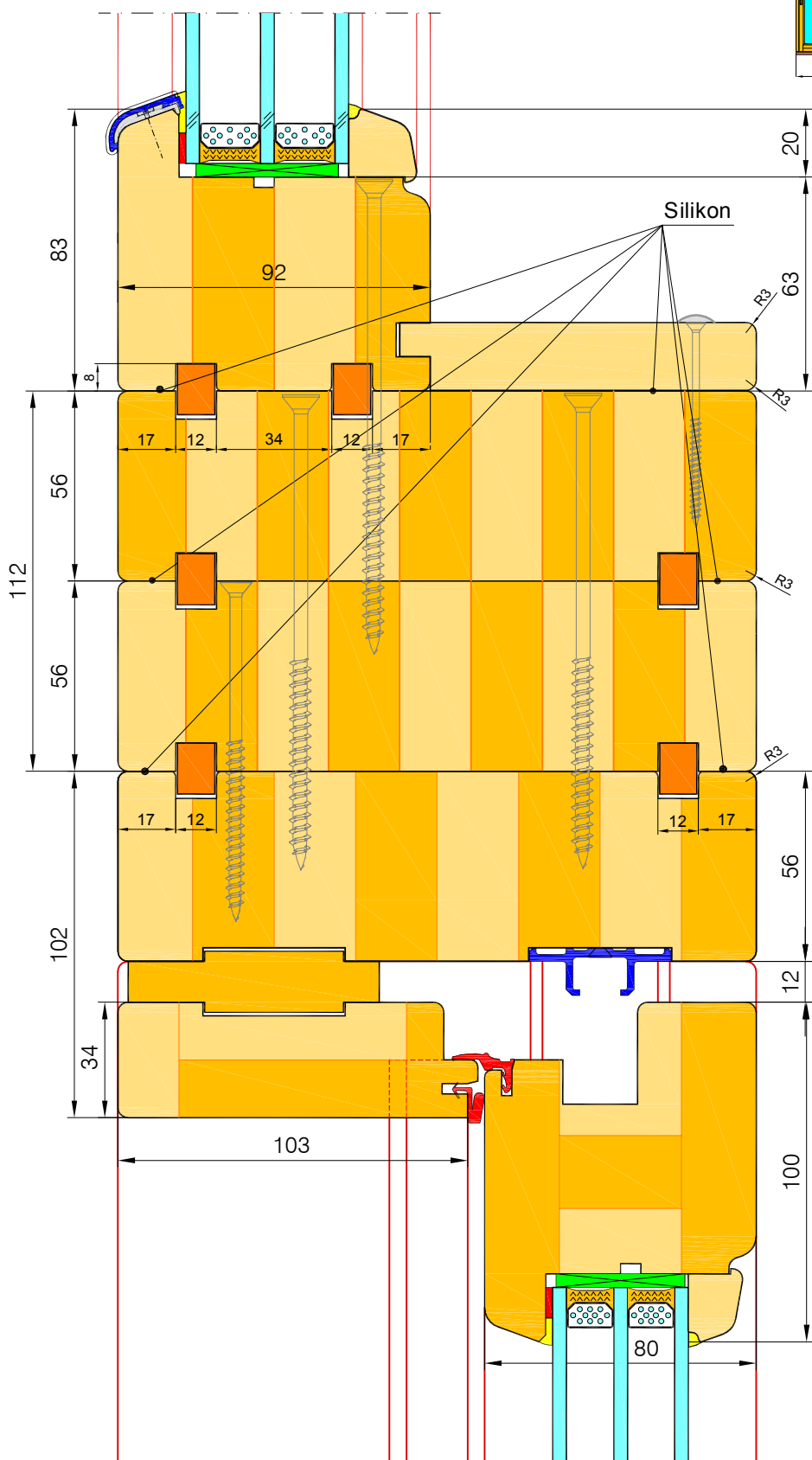

NOTE: make drilling for mounting screws. Hole diameter equal to screw core diameter.

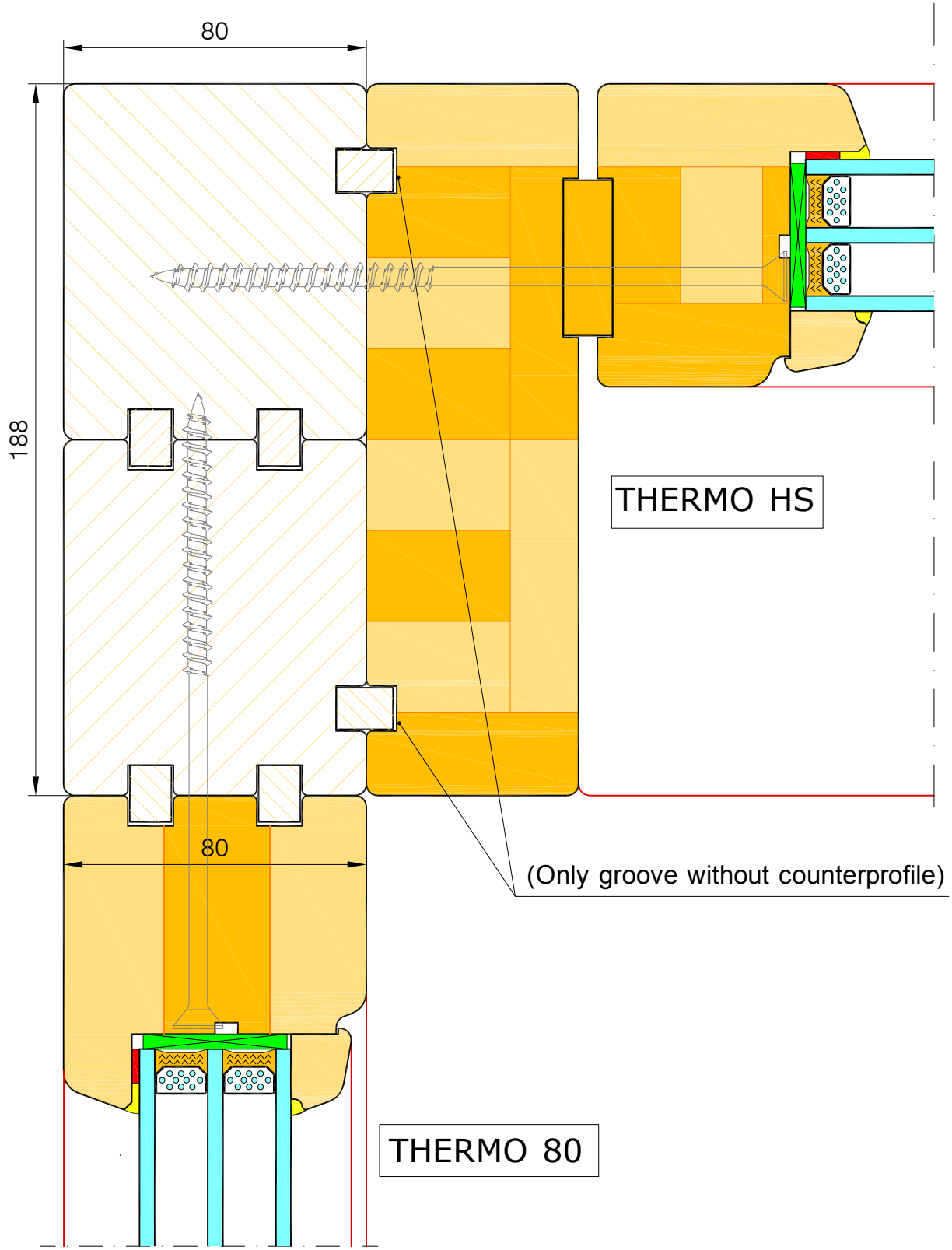

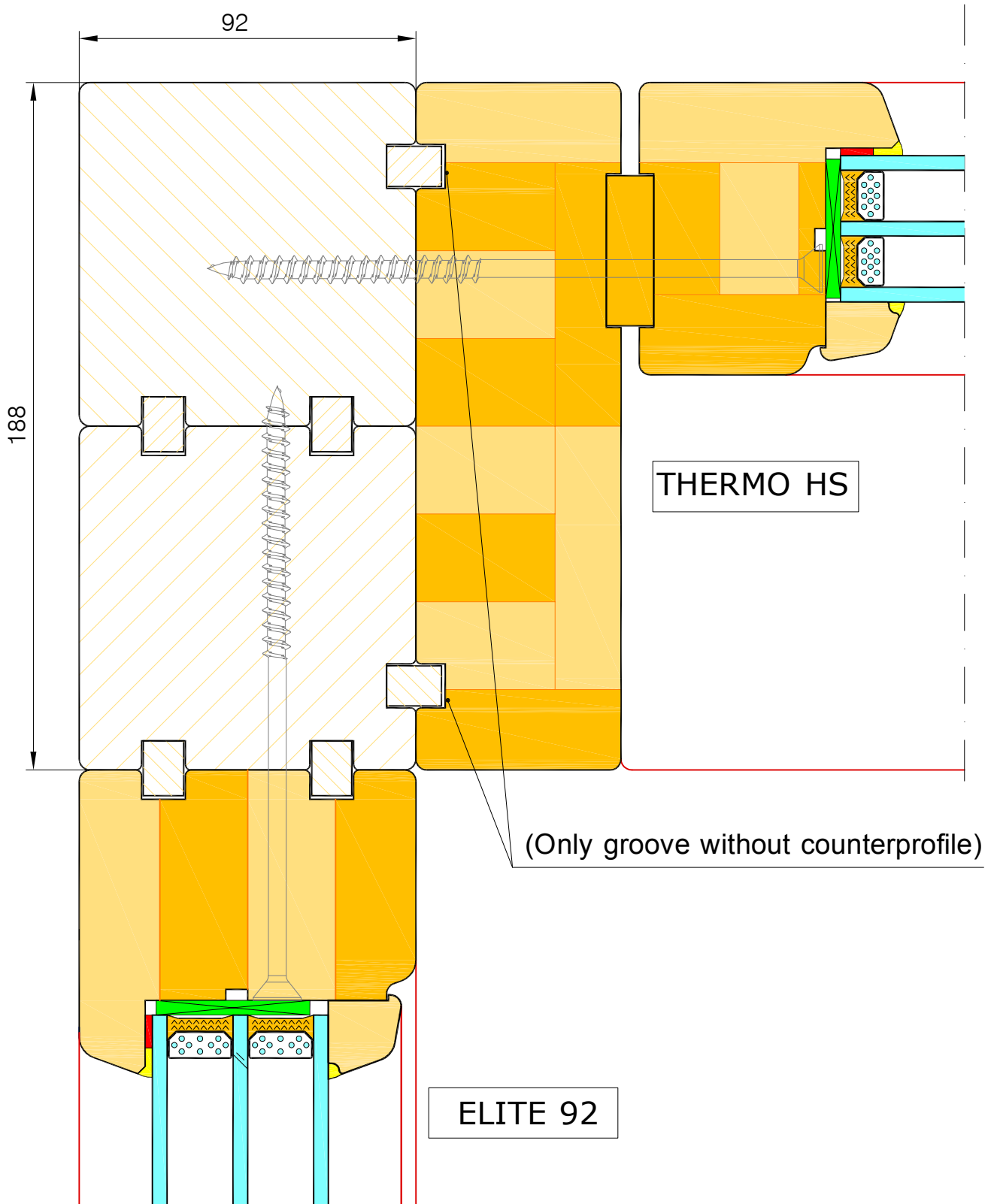

THERMO HS - Adjufix

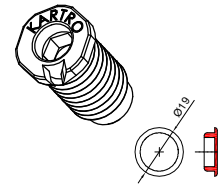
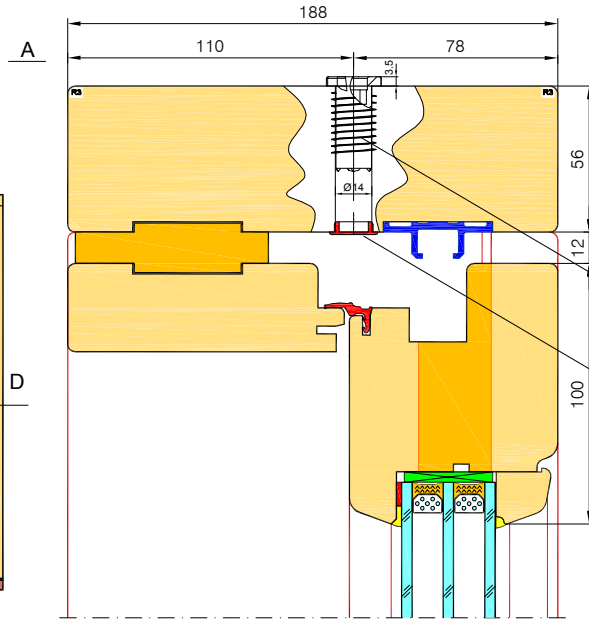
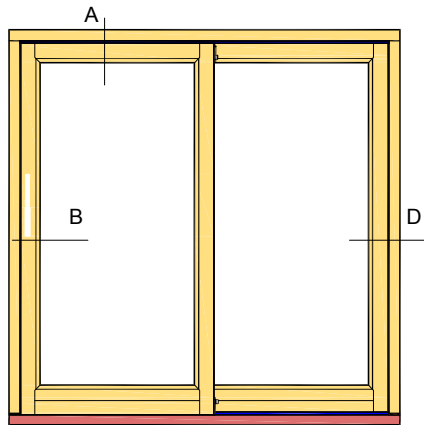

Adjufix

PVC closer
white, brown, beige

